

OPERATION AND MAINTENANCE MANUAL

EXTRACTION ARMS

Introduction

This operation and maintenance manual applies to JRV's Extraction arms. It contains important information on use, operation, maintenance, and cleaning. In addition, it contains significant information regarding safety and should therefore be read carefully before using the product.

Product Description

By connecting the extraction arm to a ventilation system, the extraction arm removes dust, smoke, fume and particles before reaching the user's breathing zone.

The extraction arm is characterised by its easy movement as well as its unique braking function that keeps the extraction arm in the desired position. For our extraction arms, hoods, source filters and other accessories or spare parts for maintenance can be selected.

Example of construction of an extraction arm, type JPL - Extraction arm for ceiling mounting

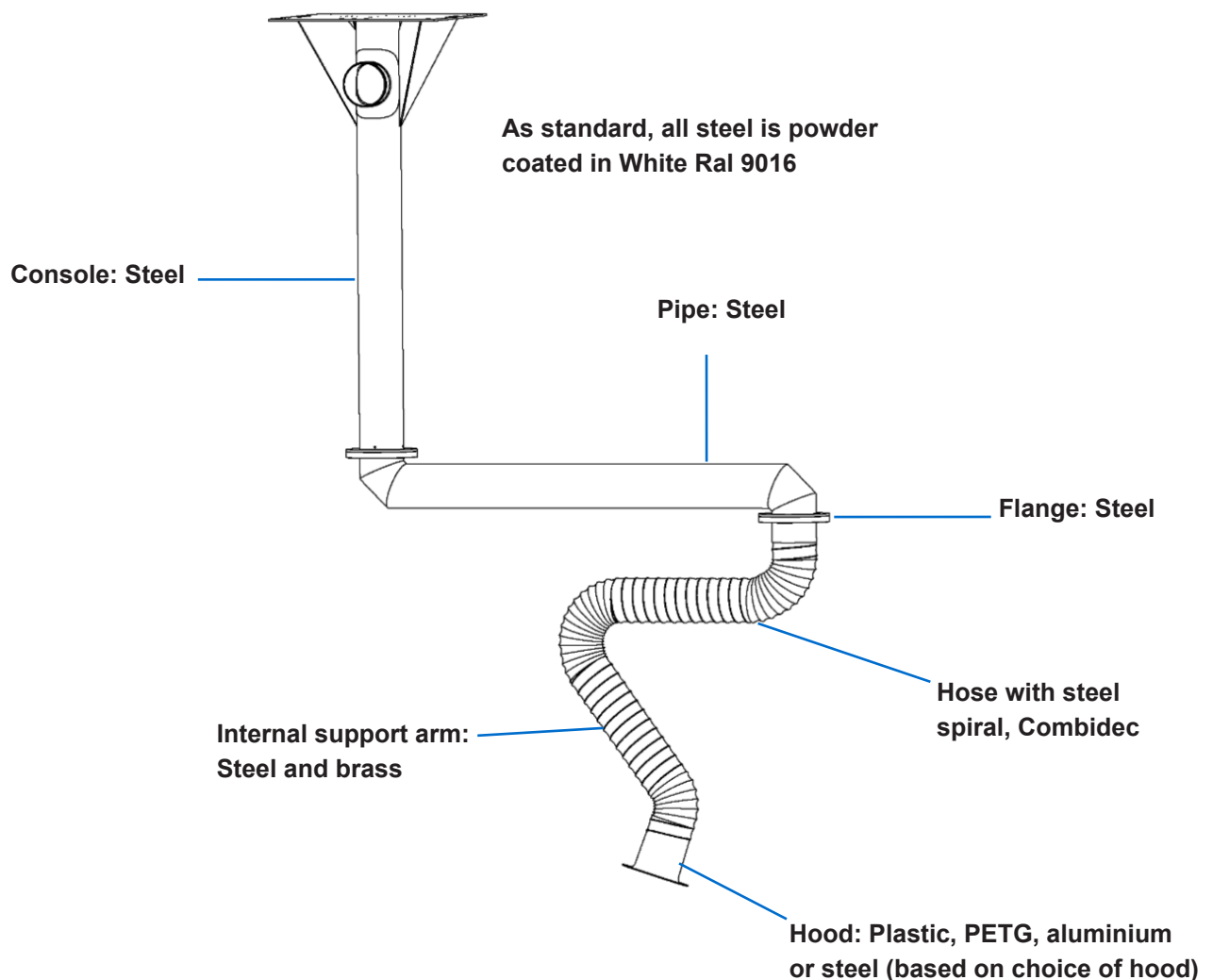

Maintenance

The following should be performed by a technician.

1 annual service inspection

JRV recommends that extraction arm is inspected at least once a year. This ensures optimal operation, extends the life of the extraction arm and reduces operating costs. JRV offers annual service inspection of your extraction (s). Depending on your wishes, a service contract can be prepared with advantage, so you do not have to worry about whether the product works optimally. Contact us for more information:

Tel.: +45 43 950 950

E-mail: sales@jrv.dk

1 annual service inspection contains:

Visible control and verification of the system, as well as retighten loose parts.

Alarm control.

Control measurement of air volumes.

Visual inspection of electrical installation.

Operation and maintenance

Based on the use of the extraction arm, you may find that the flex arm may seem more slack than normal. Using the following 5 steps, you can quickly get this done by tightening the flex arm again:

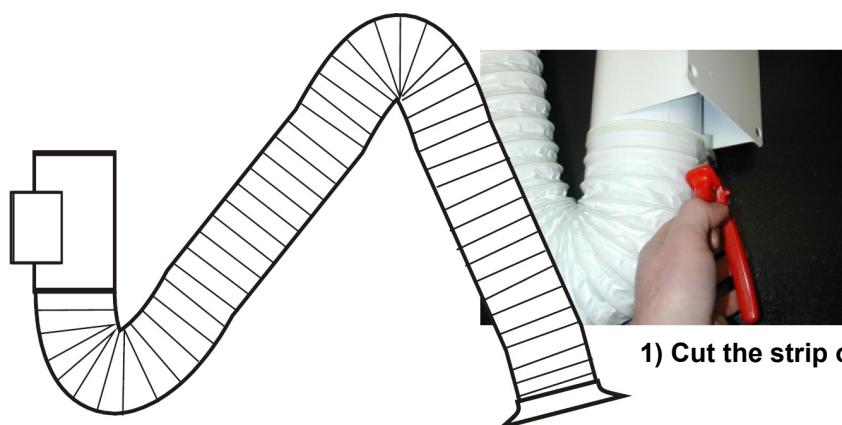

1) Cut the strip over at the console.



2) Pull the hose back.

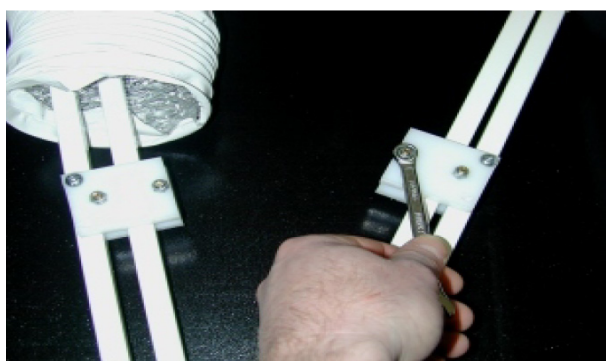

3) Tighten the nut.

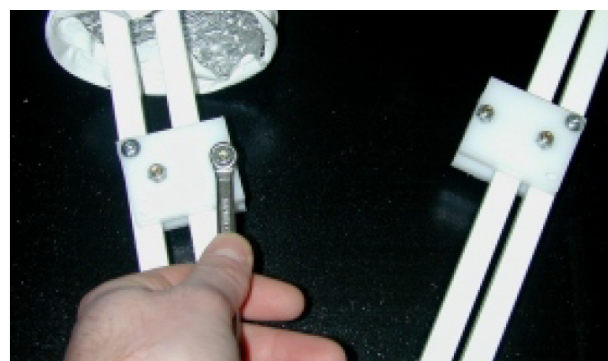



4) Pull the hose back into place.



5) Fit new strip, tighten and cut over.

Repair

All repairs that require disassembly of the system must be performed by a JRV approved workshop.

JRV disclaims any responsibility for incidents, injuries, episodes, accidents, and other unintended events that may occur due to improper or inappropriate use of the product.

By exercising common sense and consideration, as well as by following the instructions in this manual and the mounting instruction manual, there will be no unintended effects when using the product.

Warranty

The warranty period is 12 months due to defects in manufacturing and material. We also refer to our Terms of Sales and Delivery, which can be found on our website: www.jrv.dk/en.

Cleaning

To preserve the product's original surface, quality and appearance, regular cleaning is recommended

Cleaning of Extraction Arm

Can be wiped with common cleaning agents. For cleaning, it is recommended to use a soft cloth or sponge. To clean the inside of the extraction arm, the hose can be easily removed and vacuumed (see how to remove the hose under the section "Operation and maintenance").

When purchasing a hose cover, it is possible to avoid the daily cleaning of the hose on the outside. The hose cover is easily mounted around the hose and at the end of use the cover is dismantled and discarded.

Cleaning Hoods

Hoods made of:

- **Plastic / PETG**

Can be wiped with common cleaning agents or household alcohol. When using household alcohol, remove it quickly with a soft cloth. For cleaning, it is recommended to use a soft cloth or sponge. To remove soap, rinse with clean water and wipe off remaining water with a damp soft sponge / cloth.

- **Steel / Aluminium**

Can be wiped with common cleaning agents. For cleaning, a soft cloth or sponge is recommended. Always rinse with clean water and rub the surface dry. To remove soap, rinse with clean water and wipe off remaining water with a damp soft sponge / cloth. It is recommended to use steel care for cleaning and maintenance as this provides a protective film.

Cleaning of steel parts

To preserve the product's original surface, quality and appearance, regular cleaning is recommended.

Can be wiped with common cleaning agents. For cleaning, a soft cloth or sponge is recommended. Always rinse with clean water and rub the surface dry. To remove soap, rinse with clean water and wipe off remaining water with a damp soft sponge / cloth. It is recommended to use steel care for cleaning and maintenance as this provides a protective film.

Warnings for cleaning the products:

- ⚠ **NEVER** use abrasives, razor blades or other sharp tools.
- ⚠ **NEVER** use acid and solvents on the products.
- ⚠ **NEVER** use nylon sponges or similar, as this will scratch the surface. Always use only foam sponges or soft cloths.